

## 92-S-51 - SPEEDLINE System Data Sheet - Version V1 (24-10-23)

SPEEDLINE 92mm 'C' Stud Partition @600mm Ctrs,  
with Siniat GTEC 12.5mm Standard Board each  
side

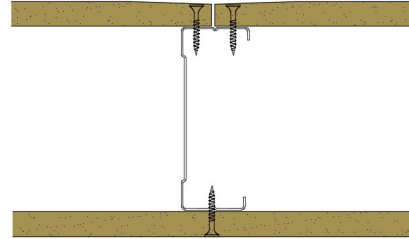

### System Performance Breakdown

Fire Resistance:

BS476 Part 22:1987:

Test Ref & Date or Applied Ref & Report:

Max Height:

Thickness:

Duty Grade: BS 5234: Part 2:1992:

Sound Insulation:

**30/30 Minutes** (Integrity/Insulation).

**BRE 269826 - BRE Report P102396-1011C**

**Refer to Speedline Specification Clause**

**119 mm.** (At Base Track, Excluding Finishes)

**Medium - Annexes A-F**

**38 R<sub>w</sub>dB**, Date Tested or Assessed Against - 70-S-51

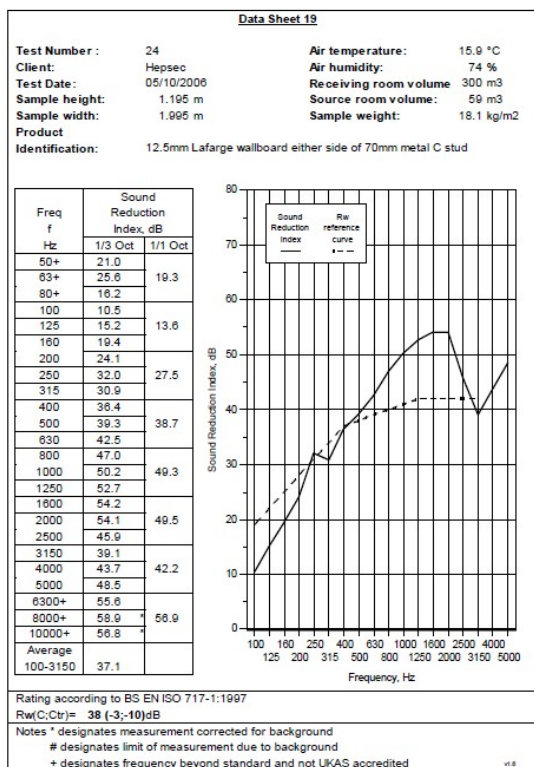

TESTED AT ONE OF THE UKAS  
ACCREDITED LABORATORIES  
BELOW

B.T.C (H-Ref on Graph)	
B.R.E	
AIRO	
S.R.L	